

TSS Countersunk preassembled nylon plug / Cheville en nylon tête fraisée clou premonté

- concrete / béton
- solid brick / brique pleine
- honeycomb brick / brique semi-pleine
- cell like clay brick / brique creuse
- light weight honeycomb brick / bloc creux Poroton
- hollow dense aggregate block / bloc creux béton
- hollow light aggregate block / bloc creux Leca
- aerated concrete / béton cellulaire
- solid stone / pierre solide



INFO page 327

White zinc plated screw
Pozidrive recess
grey plug

Vis zingué blanc
empreinte Pozidrive
cheville grise



Stainless steel A2 screw
Pozidrive recess
grey plug

Vis inox A2
empreinte Pozidrive
cheville grise

Double threaded screw
white zinc plated

Vis à deux filets
zingué blanc

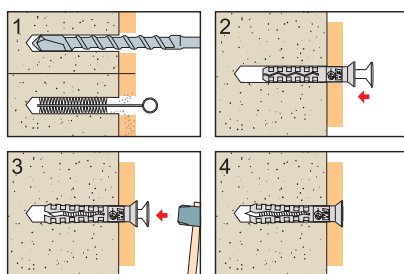

| Code | Plug Cheville Ø x L | Screw Vis Ø x L | Box q.ty Boîte de | Pkg. Cond. |
|--------------|---------------------------|-----------------------|----------------------|---------------|
| 62200b05030* | 5x30 | 3,4x35 | 300 | 3000 |
| 62200b05040* | 5x40 | 3,4x45 | 200 | 2000 |
| 62200b05050* | 5x50 | 3,4x55 | 200 | 2000 |
| 62200b06040 | 6x40 | 3,8x45 | 200 | 2000 |
| 62200b06050 | 6x50 | 3,8x55 | 100 | 1000 |
| 62200b06060 | 6x60 | 3,8x65 | 100 | 1000 |
| 62200b06080 | 6x80 | 3,8x85 | 100 | 1000 |
| 62200b08060 | 8x60 | 4,8x65 | 150 | 1500 |
| 62200b08080 | 8x80 | 4,8x85 | 150 | 1500 |
| 62200b08100 | 8x100 | 4,8x105 | 100 | 1000 |
| 62200b08120 | 8x120 | 4,8x125 | 100 | 1000 |
| 62200b08140 | 8x140 | 4,8x145 | 100 | 1000 |
| 62200b10080* | 10x80 | 7x85 | 100 | 1000 |
| 62200b10100* | 10x100 | 7x105 | 100 | 1000 |
| 62200b10135* | 10x135 | 7x140 | 50 | 500 |
| 62200b10160* | 10x160 | 7x165 | 50 | 500 |

* Sizes not covered by CE certification / Dimension non certifiée CE

| Code | Plug Cheville Ø x L | Screw Vis Ø x L | Box q.ty Boîte de | Pkg. Cond. |
|---------------|---------------------------|-----------------------|----------------------|---------------|
| 62203x05030*▲ | 5x30 | 3,4x35 | 300 | 3000 |
| 62203x05040*▲ | 5x40 | 3,4x45 | 200 | 2000 |
| 62203x05050*▲ | 5x50 | 3,4x55 | 200 | 2000 |
| 62203x06040 | 6x40 | 3,8x45 | 200 | 2000 |
| 62203x06050 | 6x50 | 3,8x55 | 100 | 1000 |
| 62203x06060 | 6x60 | 3,8x65 | 100 | 1000 |
| 62203x06080 | 6x80 | 3,8x85 | 100 | 1000 |

* Sizes not covered by CE certification / Dimension non certifiée CE

| Code | Plug Cheville Ø x L | Screw Vis Ø x L | Thread Filetage | Box q.ty Boîte de | Pkg. Cond. |
|--------------|---------------------------|-----------------------|--------------------|----------------------|---------------|
| 62202b06040 | 6x40 | 3,8x52 | M6 | 200 | 2000 |
| 62202b06050▲ | 6x50 | 3,8x66 | M6 | 100 | 1000 |
| 62204b06040▲ | 6x40 | 3,8x52 | M7 | 100 | 1000 |
| 62204b06050▲ | 6x50 | 3,8x62 | M7 | 100 | 1000 |

TBB Large rim preassembled nylon plug / Cheville en nylon à collerette large clou prémonté

- concrete / béton
- solid brick / brique pleine
- honeycomb brick / brique semi-pleine
- cell like clay brick / brique creuse
- light weight honeycomb brick / bloc creux Poroton
- hollow dense aggregate block / bloc creux béton
- hollow light aggregate block / bloc creux Leca
- aerated concrete / béton cellulaire
- solid stone / pierre solide

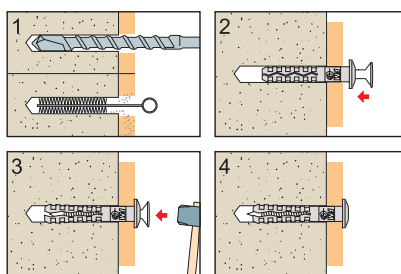

INFO page 327

White zinc plated screw
Pozidrive recess
grey plug

Vis zingué blanc
empreinte Pozidrive
cheville grise



| Code | Plug Cheville Ø x L | Screw Vis Ø x L | Box q.ty Boîte de | Pkg. Cond. |
|--------------|---------------------------|-----------------------|----------------------|---------------|
| 62100b05030* | 5x30 | 3,4x35 | 300 | 3000 |
| 62100b05040* | 5x40 | 3,4x45 | 200 | 2000 |
| 62100b05050* | 5x50 | 3,4x55 | 200 | 2000 |
| 62100b06040 | 6x40 | 3,8x45 | 200 | 2000 |
| 62100b06050 | 6x50 | 3,8x55 | 100 | 1000 |
| 62100b06060 | 6x60 | 3,8x65 | 100 | 1000 |
| 62100b08080 | 8x80 | 4,8x85 | 150 | 1500 |
| 62100b08100 | 8x100 | 4,8x105 | 100 | 1000 |
| 62100b08120 | 8x120 | 4,8x125 | 100 | 1000 |
| 62100b08140 | 8x140 | 4,8x145 | 100 | 1000 |
| 62100b08160 | 8x160 | 4,8x165 | 100 | 1000 |

* Sizes not covered by CE certification / Dimension non certifiée CE



Stainless steel A2 screw
Pozidrive recess

Vis inox A2
empreinte Pozidrive



| Grey plug Cheville grise Code | Dark brown plug Cheville marron foncé Code | Natural plug Cheville naturelle Code | Plug Cheville Ø x L | Screw Vis Ø x L | Box q.ty Boîte de | Pkg. Cond. |
|-------------------------------------|--|--|---------------------------|-----------------------|----------------------|---------------|
| 62102x06040 | 62103x06040*▲ | 62107x06040*▲ | 6x40 | 3,8x45 | 200 | 2000 |
| 62102x06050▲ | 62103x06050*▲ | 62107x06050*▲ | 6x50 | 3,8x55 | 100 | 1000 |
| 62102x06060▲ | 62103x06060*▲ | 62107x06060*▲ | 6x60 | 3,8x65 | 100 | 1000 |

* Sizes not covered by CE certification / Dimension non certifiée CE



| Black zinc ptd. screw Vis zingué noir Code | Copper ptd stain. steel A2 screw Vis inox A2 cuivre Code | Plug Cheville Ø x L | Screw Vis Ø x L | Box q.ty Boîte de | Pkg. Cond. |
|--|--|---------------------------|-----------------------|----------------------|---------------|
| 62109e05030* | 62105005030*▲ | 5x30 | 3,4x35 | 300 | 3000 |
| 62109e05040* | | 5x40 | 3,4x45 | 200 | 2000 |
| 62109e05050* | 62105005050* | 5x50 | 3,4x55 | 200 | 2000 |
| 62109e06040* | 62105006040* | 6x40 | 3,8x45 | 200 | 2000 |
| 62109e06050* | 62105006050*▲ | 6x50 | 3,8x55 | 100 | 1000 |
| 62109e06060* | 62105006060*▲ | 6x60 | 3,8x65 | 100 | 1000 |

* Sizes not covered by CE certification / Dimension non certifiée CE

TPP Cylindrical head preassembled nylon plug / *Cheville en nylon tête cylindrique clou prémonté*

- concrete / *béton*
- solid brick / *brique pleine*
- honeycomb brick / *brique semi-pleine*
- cell like clay brick / *brique creuse*
- light weight honeycomb brick / *bloc creux Poroton*
- hollow dense aggregate block / *bloc creux béton*
- hollow light aggregate block / *bloc creux Leca*
- aerated concrete / *béton cellulaire*
- solid stone / *pierre solide*

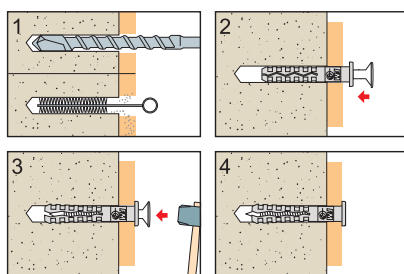

INFO page 327

White zinc plated screw
Pozidrive recess
grey plug

Vis zingué blanc
empreinte Pozidrive
cheville grise



| Code | Plug Cheville Ø x L | Screw Vis Ø x L | Box q.ty Boîte de | Pkg. Cond. |
|-----------------|---------------------------|-----------------------|----------------------|---------------|
| 62700b05030* | 5x30 | 3,4x35 | 300 | 3000 |
| 62700b05040* | 5x40 | 3,4x45 | 200 | 2000 |
| 62700b05050* | 5x50 | 3,4x55 | 200 | 2000 |
| 62703b06035*(1) | 6x35 | 3,8x40 | 200 | 2000 |
| 62700b06040 | 6x40 | 3,8x45 | 200 | 2000 |
| 62700b06050 | 6x50 | 3,8x55 | 100 | 1000 |
| 62700b06060 | 6x60 | 3,8x65 | 100 | 1000 |
| 62703b08040*(1) | 8x40 | 4,8x45 | 200 | 2000 |
| 62700b08060 | 8x60 | 4,8x65 | 150 | 1500 |
| 62700b08080 | 8x80 | 4,8x85 | 150 | 1500 |
| 62700b08100 | 8x100 | 4,8x105 | 100 | 1000 |
| 62700b08120 | 8x120 | 4,8x125 | 100 | 1000 |
| 62700b08140 | 8x140 | 4,8x145 | 100 | 1000 |

(1) With reduced embedment depths / *Avec profondeur de pose réduite*

* Sizes not covered by CE certification / *Dimension non certifiée CE*



Stainless steel A2 screw
Pozidrive recess
grey plug

Vis inox A2
empreinte Pozidrive
cheville grise



| Code | Plug Cheville Ø x L | Screw Vis Ø x L | Box q.ty Boîte de | Pkg. Cond. |
|-------------|---------------------------|-----------------------|----------------------|---------------|
| 62701x06040 | 6x40 | 3,8x45 | 200 | 2000 |
| 62701x06050 | 6x50 | 3,8x55 | 100 | 1000 |
| 62701x06060 | 6x60 | 3,8x65 | 100 | 1000 |
| 62701x08080 | 8x80 | 4,8x85 | 150 | 1500 |